

F. E. WARREN AIR FORCE BASE AIR FORCE FACILITIES

ATLAS "E" SITES:

**Site 8 4 miles southwest of Kimball, Kimball County, NE**

Owner:	Buying on contract:	2 Wells
Raymond T. Foster	Dennis Burns	Owner does not use
Hugh M. Foster	South Route 2, Box 32	
700 Central Avenue	Kimball, NE 69145	
Horton, Kansas 66439	308-437-5455	
Home: 913-486-3501		
Work: 913-486-2159		

(During visit in 1986, using site for storage)

Also need to sample at adjacent owner:  
Shonna or Lyle Yung  
Lives 1/2 mile from Burns property.  
308-235-2074

**Site 10 Briggsdale, Weld County in Arapahoe Forest, CO**

*Called 19 Aug 1994 to Mr. Losche	
Department of Agriculture	2 Wells
Forest Service	One used for cattle (no problems)
Pawnee National Grassland	(Powered by windmill-May be difficult to
660 "O" Street	obtain sample)
Greeley, CO 80631	2nd one never used
	(Could never get it working)
POC: Jeffrey Losche 303-353-5004	
(Owned since 1967 - not used - covered U/G facilities with dirt)	

**Site 11 13 miles north of Nunn, 1 mile south of US Hwy 40 Weld County, CO**  
(25 miles north of Greeley on Hwy 85, east approx. 4 miles,  
north one mile)

*Called 19 Aug 1994 to Mr. Caldwell	
Colorado Engineering Experiment Station, Inc.	2 Wells
8310 Hoyt Way	Northwestern well used for drinking
Arvada, CO	Southwestern well not used much,
POC at Lab: Steve Caldwell 303-897-2711	but can start pump for us
(Research lab)	Never sampled water - said it's
	great tasting water
*Talk to Don Kinney when we come to sample, as Mr. Caldwell	
will be gone the week of the 29th.	

**Site 12 Windsor, Weld County, CO**  
(5 miles SE of Windsor, off of Hwy 257)

\*Called 19 Aug 1994 to Mr. Persichino  
Environmental Science Services Admin  
Gordon Lacey, Chairman, Board of Commissioners  
Post Office Box 758  
Greeley, CO 80632  
303-356-4000 Ext. 4224 Speak to: Mr. Pat Persichino  
(Owned since 1967 - Weld County maintains the site as  
Missile Site Park and for county vehicle storage & files)  
Park Manager: Bill Harold

2 Wells  
Both used for park restrooms,  
trailer house for park mgr,  
and irrigation  
Have water tested, but don't  
keep.  
They put new pipe down one well-  
doesn't know depth

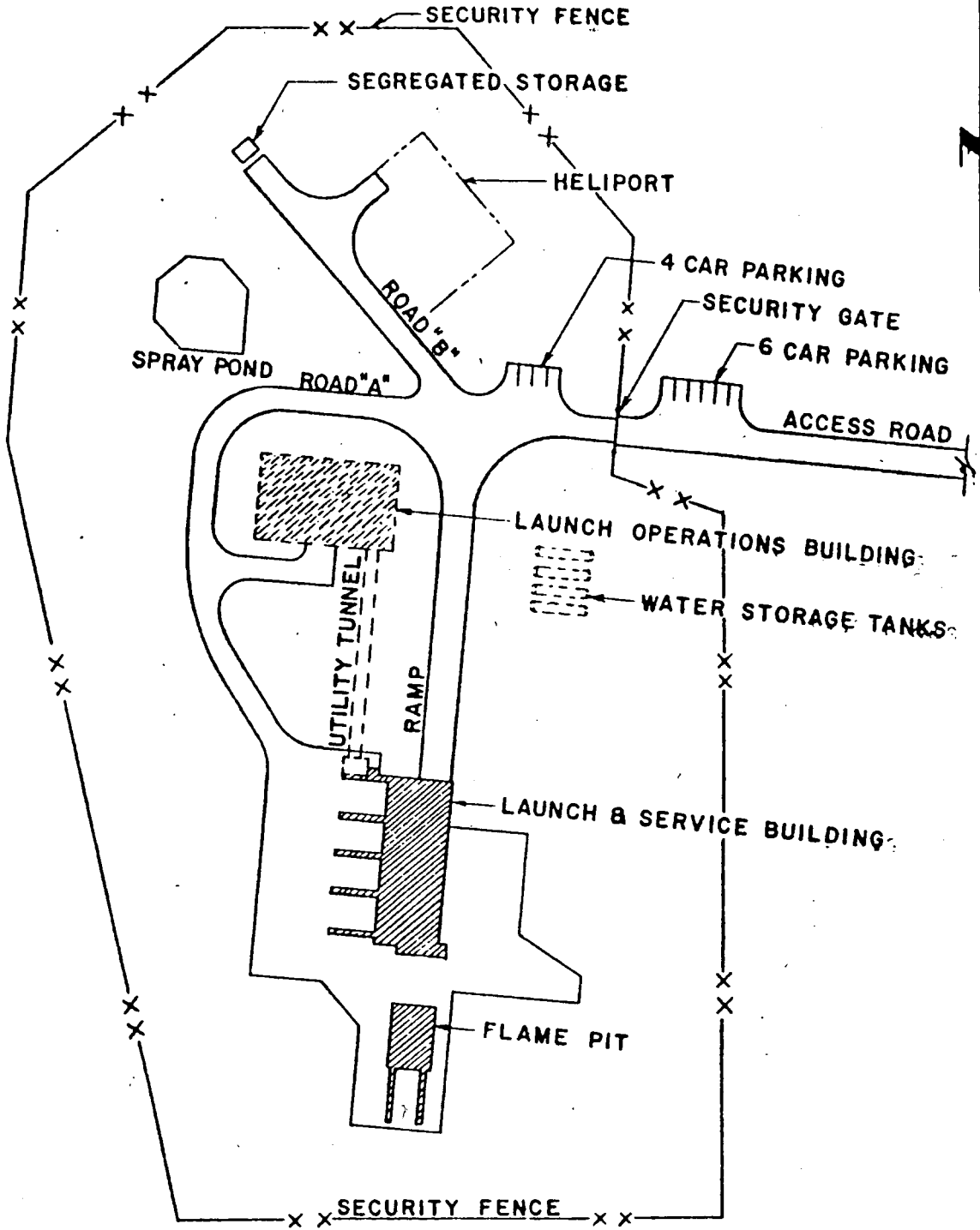

AIR FORCE BALLISTIC MISSILE DIVISION  
LAUNCHING SITES 549-2, 4, 6, 7 & 8  
SITE PLAN

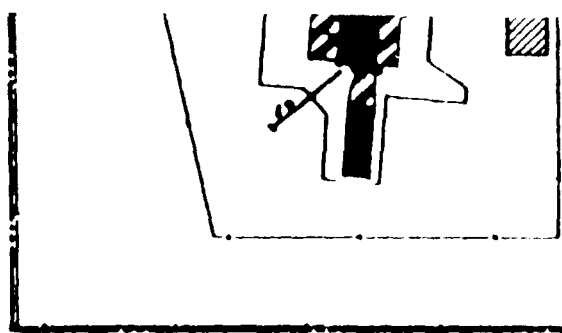

SITE 10

Site 8

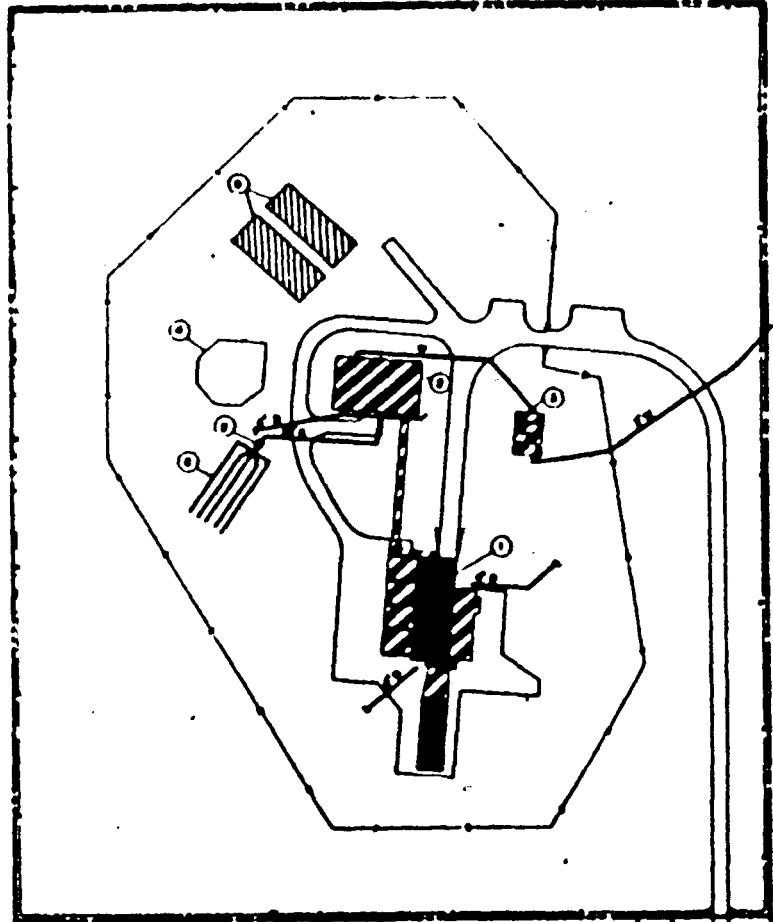

SITE 9

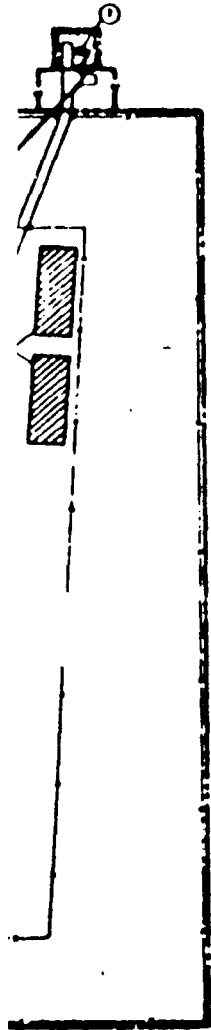

ASB

STATE HWY 14

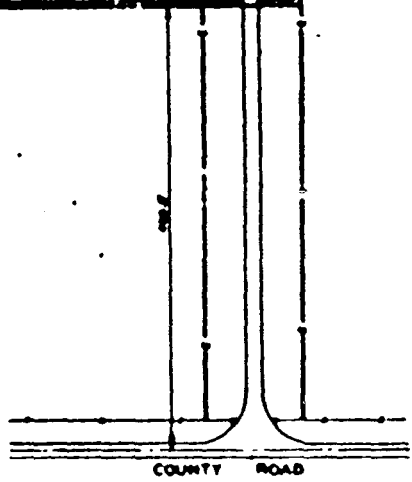

Site 10

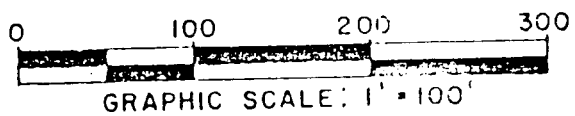
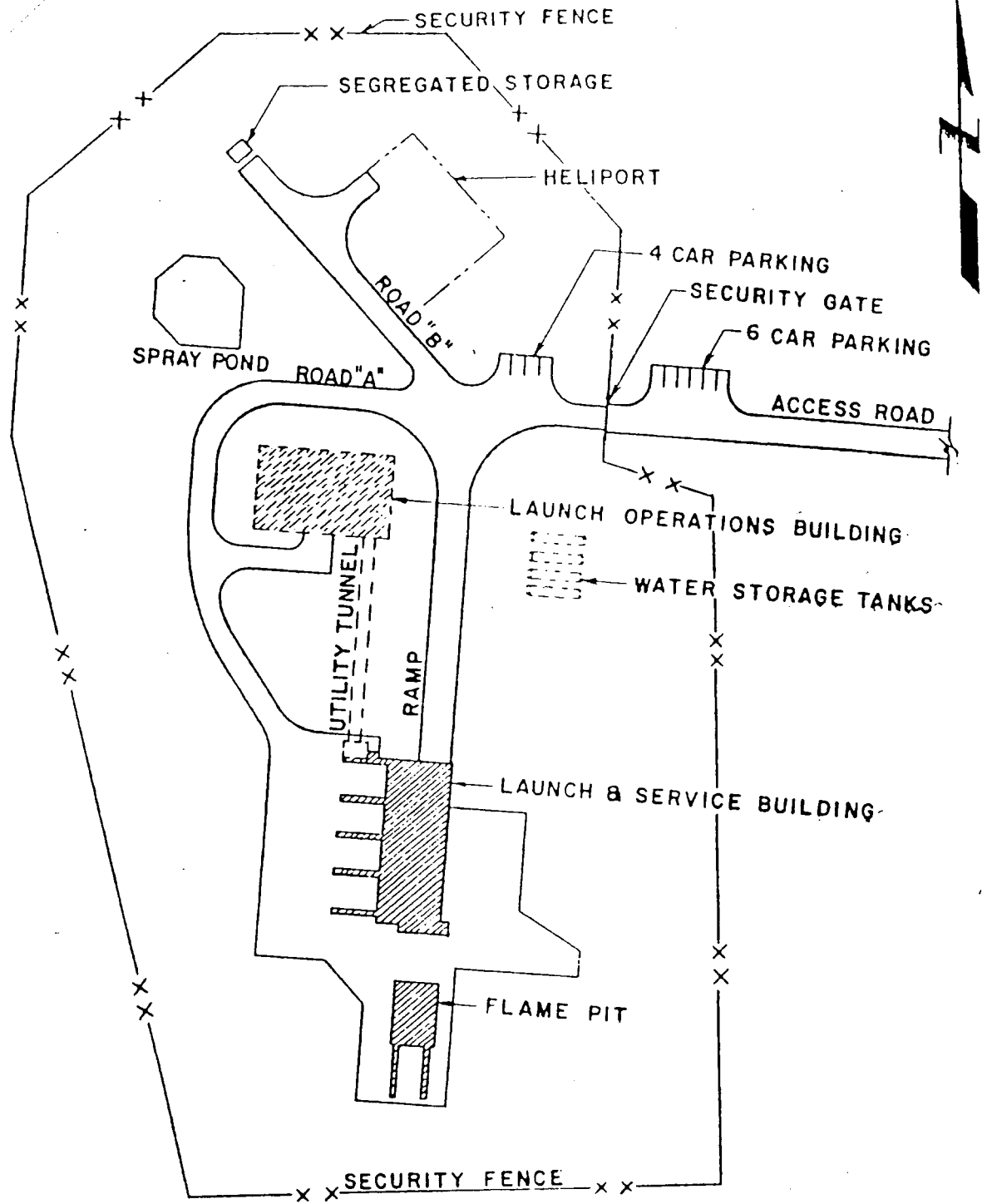

AIR FORCE BALLISTIC MISSILE DIVISION  
LAUNCHING SITES 549-2, 4, 6, 7 & 8  
SITE PLAN

ENCL 12

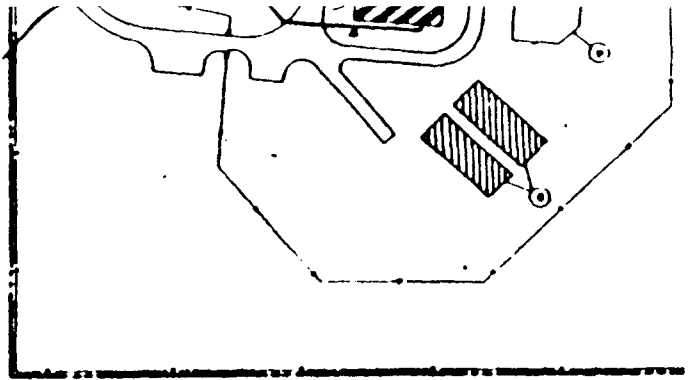

SITE 10

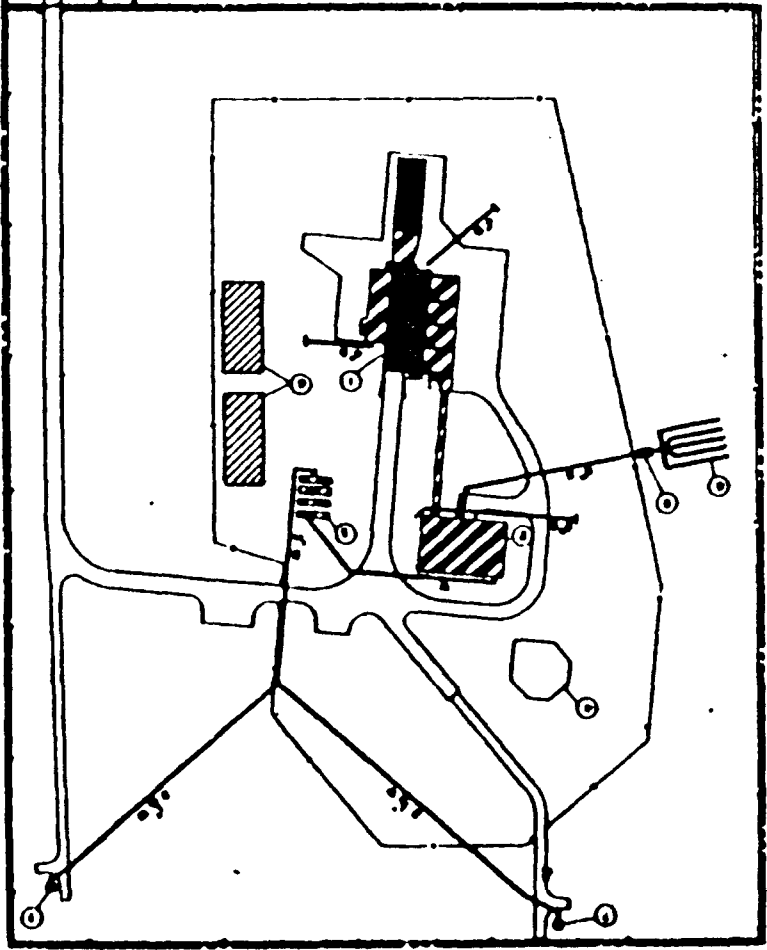

- LEGEND**
- STRUCTURES
    - EXISTING PERMANENT
    - UNDEVELOPED PERMANENT
    - EXISTING NON-PERMANENT
  - ROADS & DRIVEWAYS
    - EXISTING TO BE MAINTAINED
    - EXISTING TO BE REMOVED
  - BOUNDARIES
    - EXISTING PROPERTY LINE
    - EXISTING EASEMENT LINE
    - EXISTING PACE
  - UTILITIES
    - SEWERAGE
    - WATER LINE
    - STORM LINE
    - SEWERAGE

Site 10

Site 11

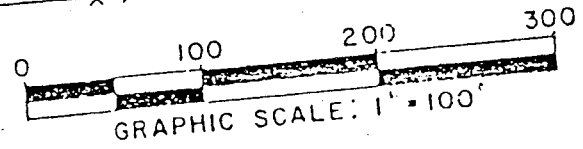
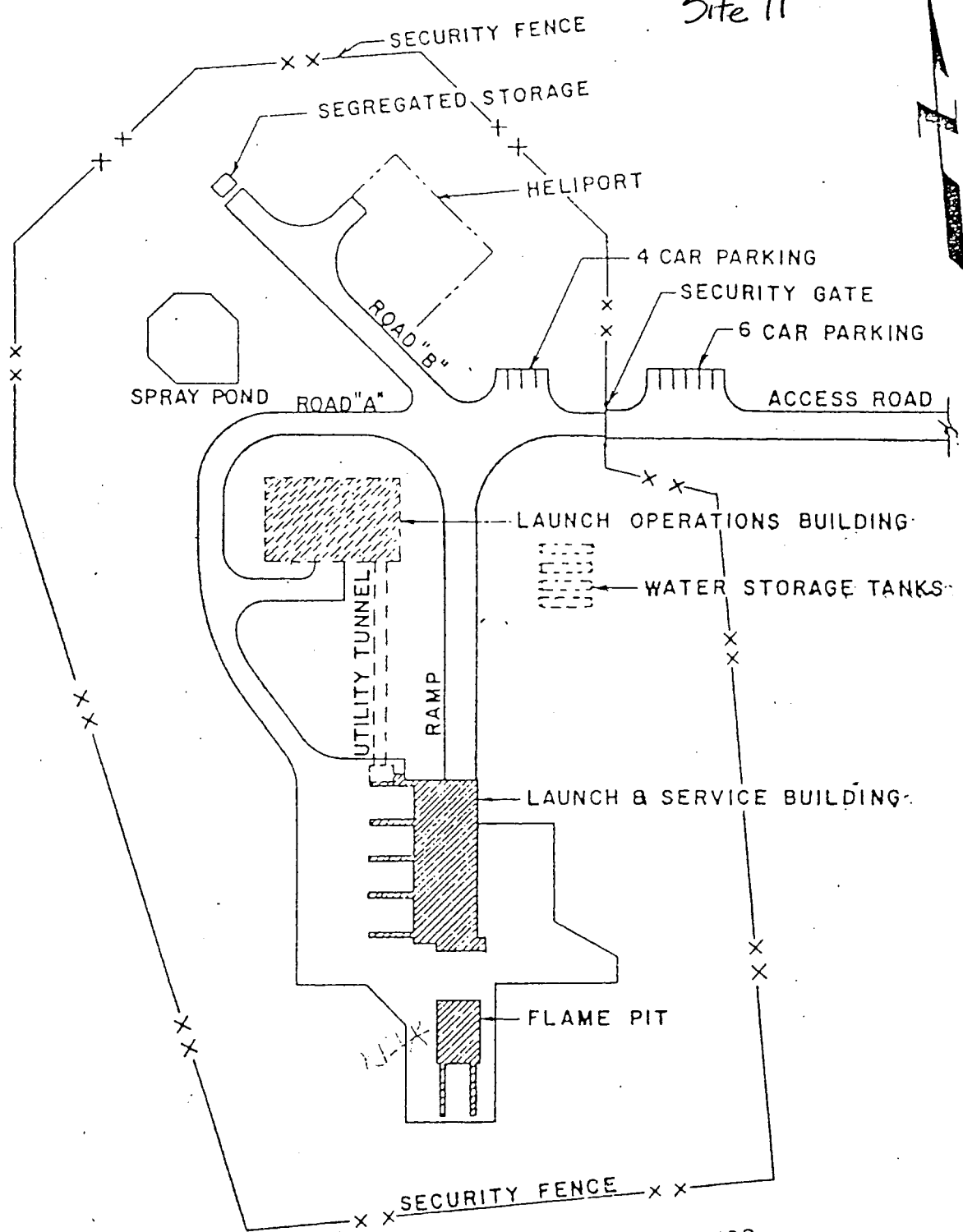

AIR FORCE BALLISTIC MISSILE DIVISION  
LAUNCHING SITES 549-2, 4, 6, 7 & 8  
SITE PLAN

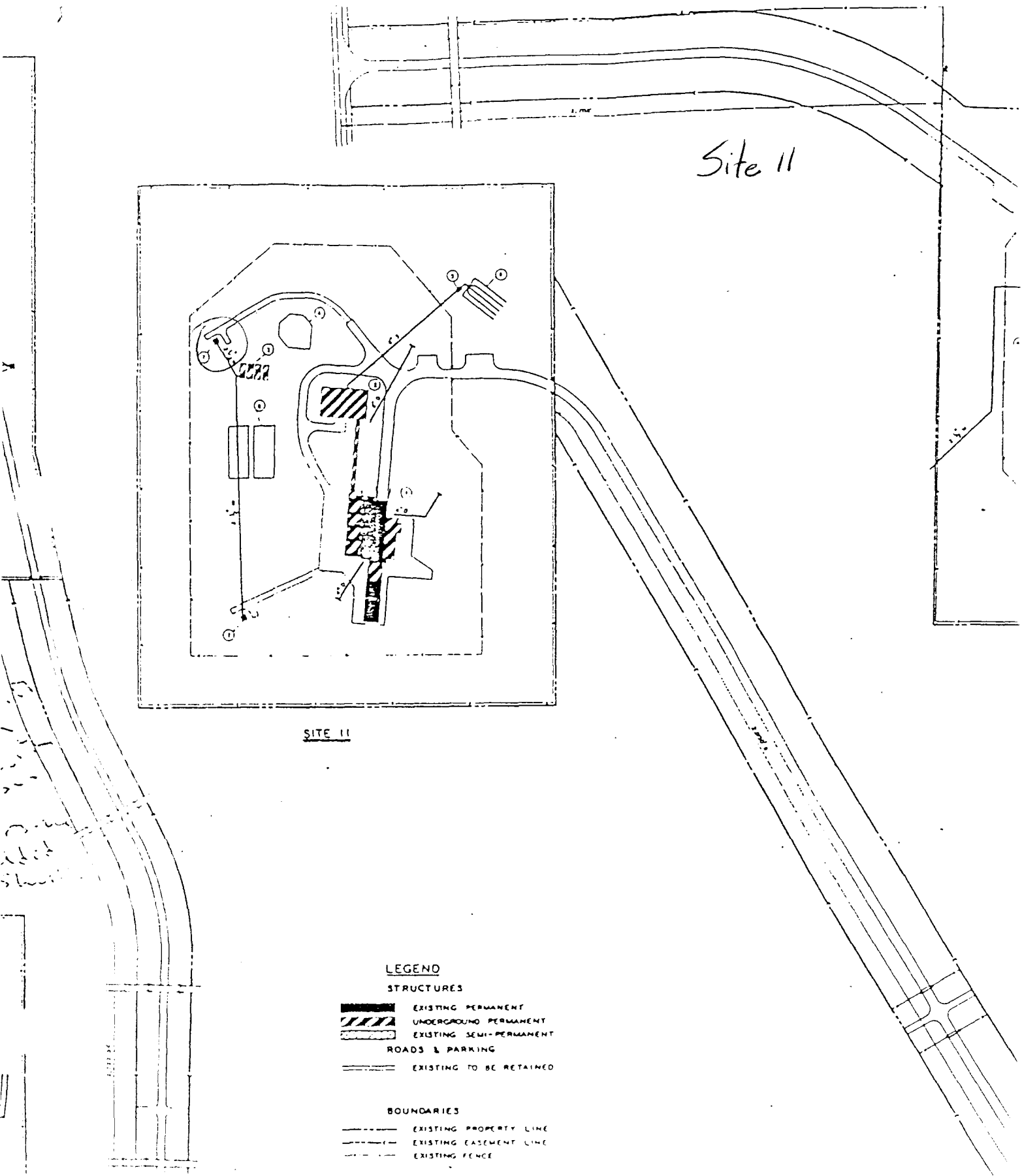



Site II

SITE II

**LEGEND**



**STRUCTURES**

-  EXISTING PERMANENT
-  UNDERGROUND PERMANENT
-  EXISTING SEMI-PERMANENT

**ROADS & PARKING**

-  EXISTING TO BE RETAINED

**BOUNDARIES**

-  EXISTING PROPERTY LINE
-  EXISTING EASEMENT LINE
-  EXISTING FENCE



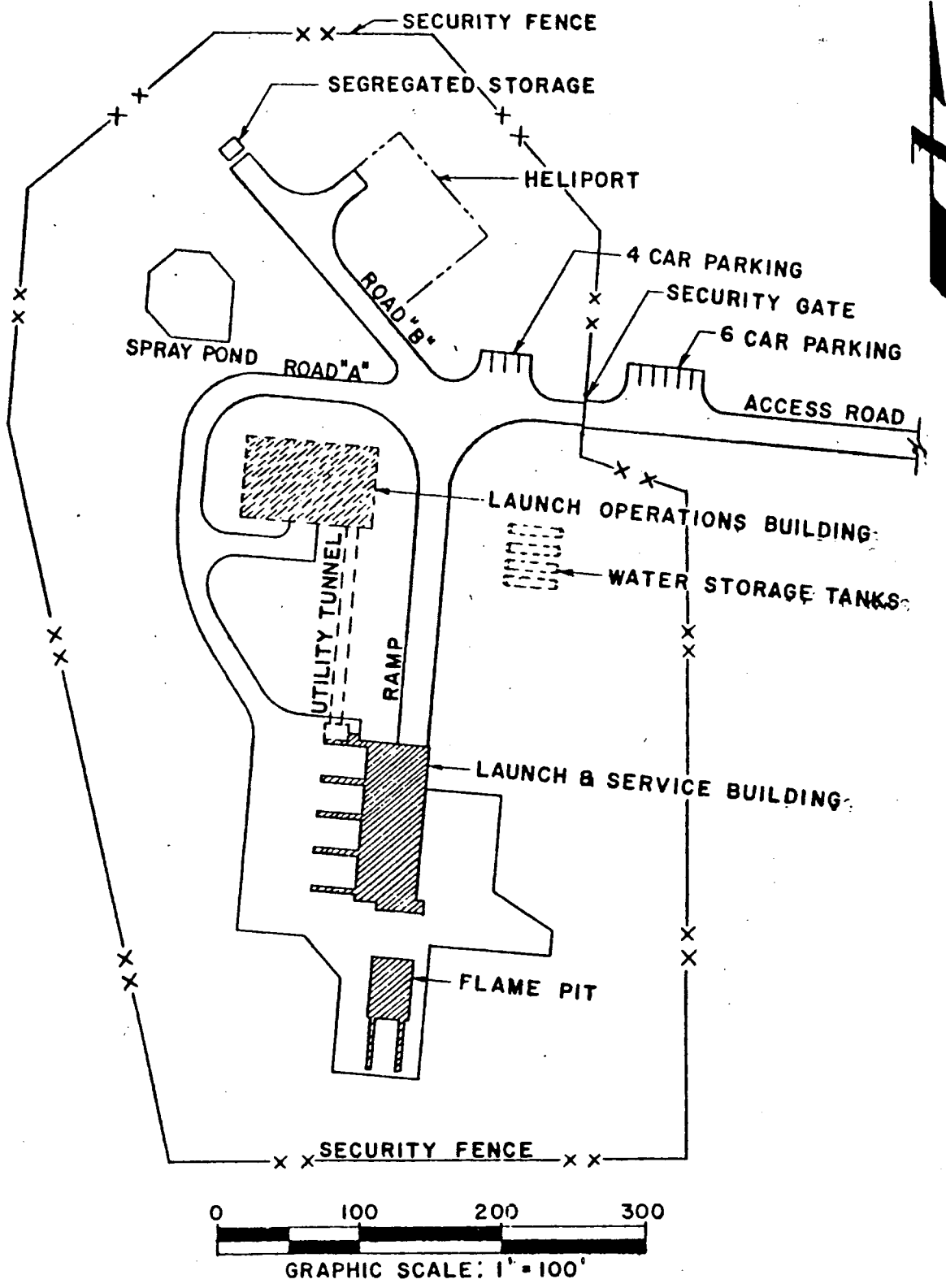

**AIR FORCE BALLISTIC MISSILE DIVISION  
LAUNCHING SITES 549-2, 4, 6, 7 & 8  
SITE PLAN**

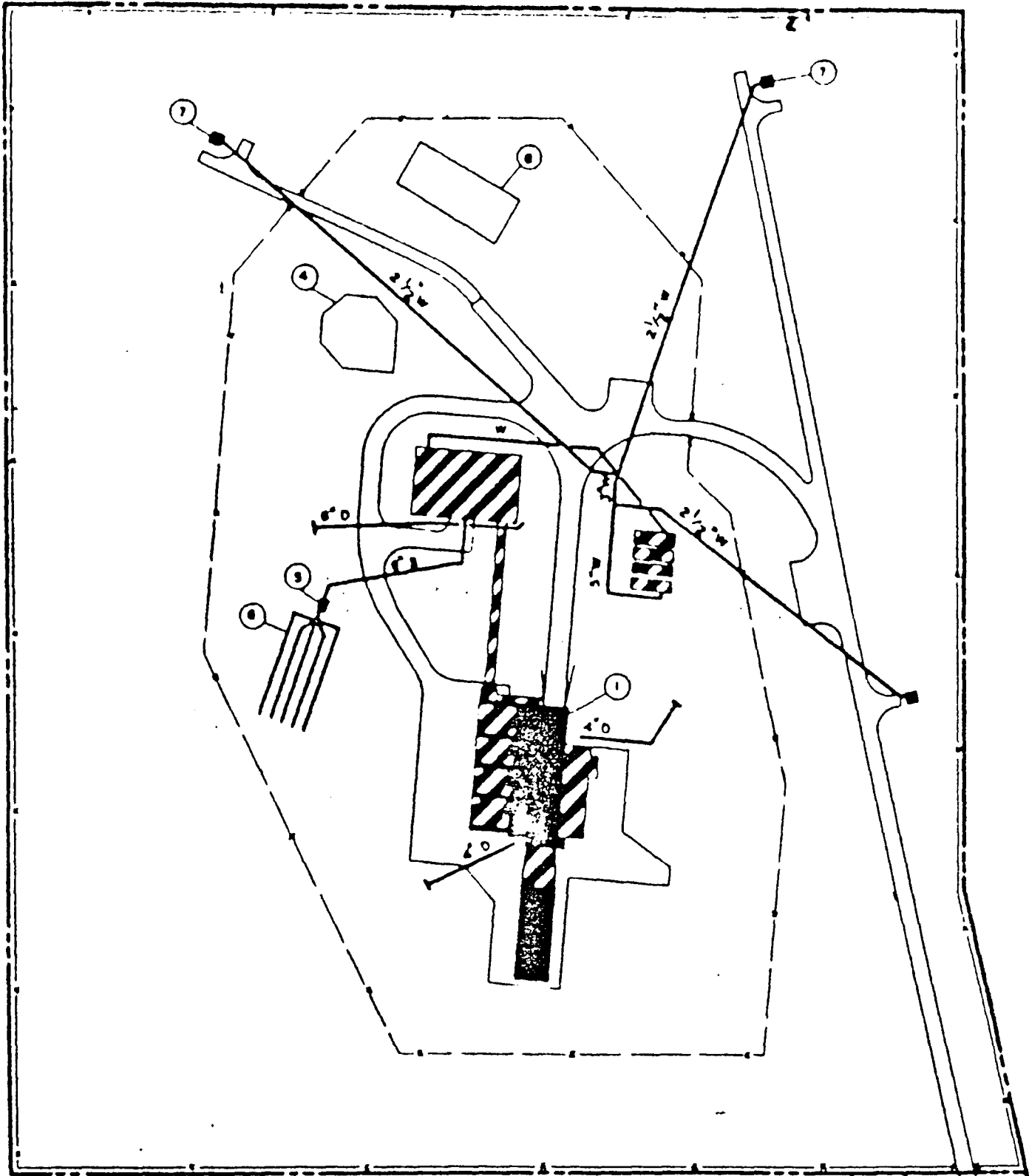

SITE 12

**TO:** Jeff Hubbard (CEMRO-ED-ER)  
**FROM:** Janelle Mavis (CEMRO-ED-DK)

**LOCATION:** Atlas Site 8 near Kimball, NE  
**SUBJECT:** List of parameters for the sampling and analysis

**DATE:** 31 August 1994

The following is a list of questions to be answered by the landowner:

- 1) The capacity of the well (gallons per minute)? \_\_\_\_\_  
(If the landowner doesn't know the capacity, does he have a copy of the well permit or an identification to trace the permit at the State office)
  - 2) The depth of the well (feet to the well screen)? \_\_\_\_\_
  - 3) To get a copy of the well pump curve.
  - 4) What functions does the well serve? (for example: domestic or household use, watering of livestock and yard animals, irrigation of lawn)
- 
- 

The following is a list of basic water quality analytical parameters needed:

- |                                 |                                |
|---------------------------------|--------------------------------|
| 1. pH                           | 8. Chlorides                   |
| 2. TDS (Total Dissolved Solids) | 9. Sulfates                    |
| 3. Nitrates                     | 10. Magnesium (Mg)             |
| 4. Alkalinity                   | 11. Iron (Fe)                  |
| 5. Bicarbonates                 | 12. Total Organic Carbon (TOC) |
| 6. Calcium                      | 13. Manganese (Mn)             |
| 7. Florides                     | 14. Silicates (SiO2)           |

It is assumed that a carbon adsorption unit will be placed either in the landowner's trailer or on the well head.